



KONICA MINOLTA

bizhub C654e

✍ Colour A3 multifunctional

✍ Up to 60/65 ppm in colour/black & white

✍ Functionality



- Colour
- Black & white

Copying



- Super G3 Fax
- PC-Fax
- i-Fax
- IP-Fax

Faxing



- Colour
- Black & white
- PCL/PS
- Local/Network
- USB

Printing



- Reprint
- Distribution
- Sharing
- Box-to-Box
- Box-to-USB

Box



- Colour
- Black & white
- Scan-to-eMail
- Scan-to-Me
- Scan-to-SMB
- Scan-to-Home
- Scan-to-FTP
- Scan-to-HDD
- Scan-to-Box
- Scan-to-USB
- Scan-to-WebDAV
- Scan-to-DPWS
- TWAIN Network

Scanning

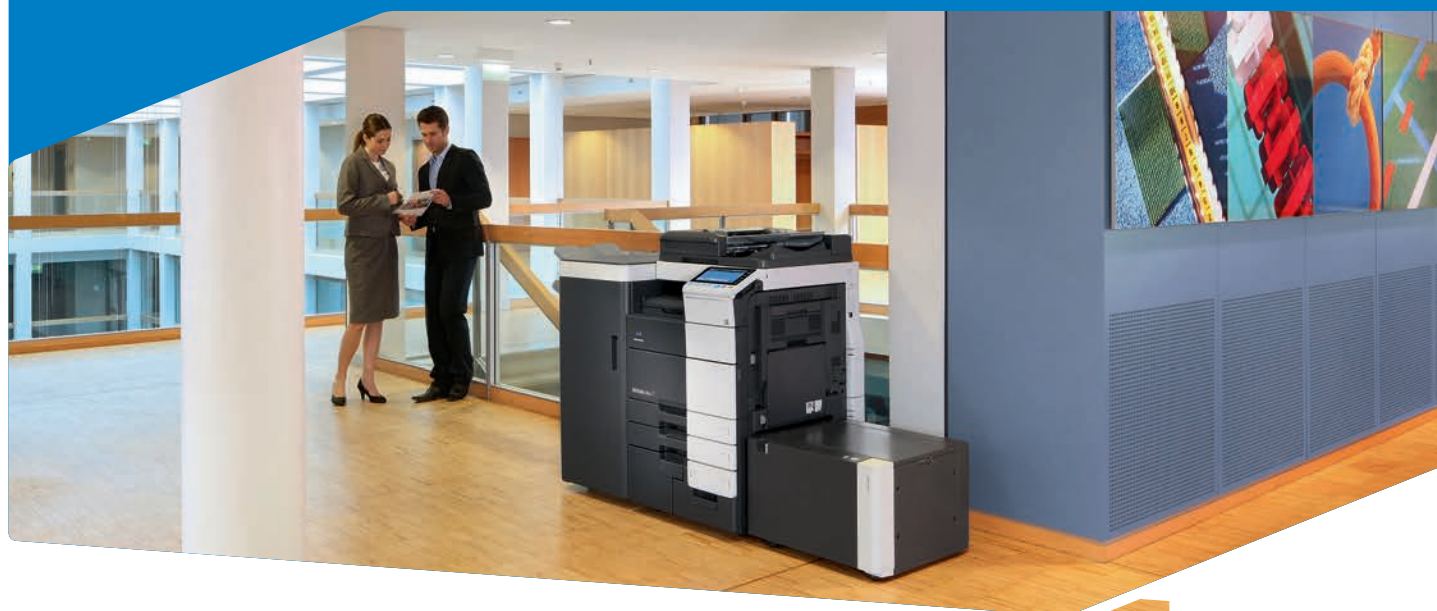

Technology



Option diagram

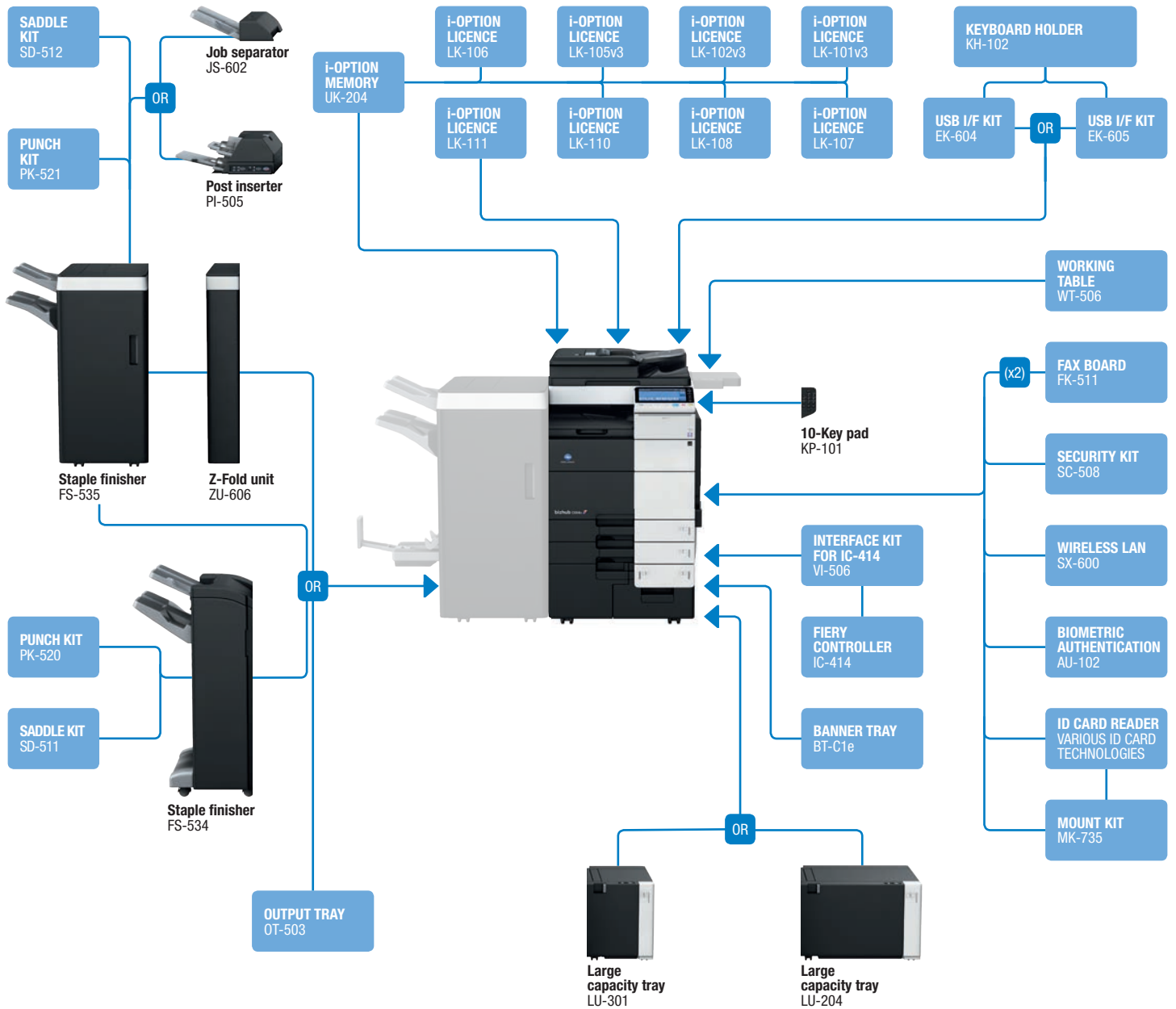

Finishing options

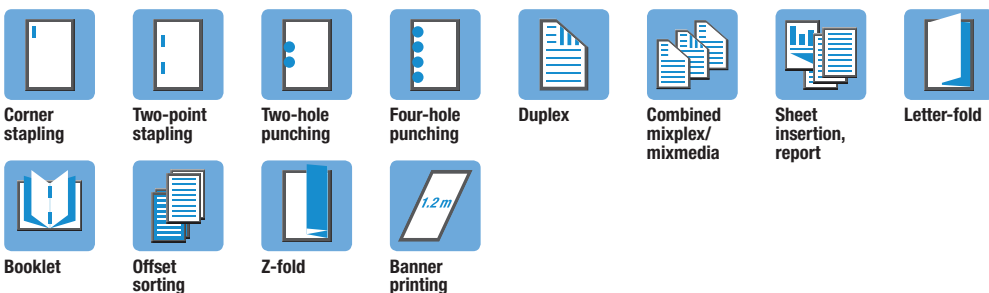

Descriptions

bizhub C654e	Communication centre with 65 ppm b/w and 60 ppm colour. Standard Emperon™ print controller with PCL 5c; PCL 6, PostScript 3, PDF 1.7, OOXML and XPS support. Paper capacity of 500 + 500 + 1000 + 1500 sheets and 150-sheet manual bypass. Media from A6 to SRA3, 1.2 m banner and 52 – 300 gsm. 2 GB memory, 250 GB hard disc and Gigabit Ethernet standard
LU-204 Large capacity tray	A4–SRA3, 2,500 sheets, 52–256 gsm
LU-301 Large capacity tray	A4, 3,000 sheets, 52–256 gsm
FS-534 Staple finisher	50-sheet stapling, 3,300 sheets max. output
PK-520 Punch kit for FS-534	2/4 hole punching, autoswitching
SD-511 Saddle kit for FS-534	Booklet finishing, half-fold, letter-fold
FS-535 Staple finisher	100 sheets stapling, 3,200 sheets max. output
PK-521 Punch kit for FS-535	2/4 hole punching, autoswitching
SD-512 Saddle kit for FS-535	Booklet finishing, half-fold, letter-fold
PI-505 Post inserter for FS-535	Cover insertion, post finishing
JS-602 Job separator for FS-535	Separation for fax output etc.
ZU-606 Z-fold unit for FS-535	Z-fold for A3 prints, 2/4 hole punching
OT-503 Output tray	Output tray used instead of finisher
KP-101 10-Key pad	For use instead of touchscreen
WT-506 Working table	Authentication device placement

FK-511 Fax board	Super G3 fax, digital fax functionality
IC-414 Fiery controller	Professional colour print controller
VI-506 Interface kit for IC-414	Fiery controller interface card
KH-102 Keyboard holder	To place USB keyboard
EK-604 USB I/F kit	USB keyboard connection
EK-605 USB I/F kit	USB keyboard connection, Bluetooth
ID card reader	Various ID card technologies
MK-735 Mount kit	Installation kit for ID card reader
AU-102 Biometric authentication	Finger vein scanner
SC-508 Security kit	Copy Guard function (2 x required)
BT-C1e Banner tray	Multi-page banner feeding
LK-101v3 i-Option licence	Web browser
LK-102v3 i-Option licence	PDF/A, PDF encryption, digital signature
LK-105v3 i-Option licence	Searchable PDF and PPTX
LK-106 i-Option licence	Printing of barcode fonts
LK-107 i-Option licence	Printing of Unicode fonts
LK-108 i-Option licence	Printing of OCR (A and B) fonts
LK-110 i-Option licence	Generates various file formats incl. DOCX and XLSX
LK-111 i-Option licence	Native ThinPrint client
UK-204 i-Option Memory	Memory extension for i-Options
SX-600 Wireless LAN	Wireless LAN to network connector

Technical specifications

COPIER SPECIFICATIONS

Copying process	Electrostatic laser copy, tandem, indirect
Toner system	Simitri® HD polymerised toner
Copy/print speed A4 (mono/colour)	Up to 65 ppm Up to 60 ppm
Copy/print speed A3 (mono/colour)	Up to 33 ppm Up to 30 ppm
Autoduplex speed A4 (mono/colour)	Up to 65 ppm Up to 60 ppm
1st copy out time (mono/colour)	3.7 sec. 5.3 sec.
Warm-up time	Approx. 22 sec. ¹
Copy resolution	600 x 600 dpi
Gradation	256 gradations
Multicopy	1 – 9,999
Original format	A5 – A3
Magnification	25 – 400 % in 0.1 % steps; auto-zooming
Copy functions	Chapter; cover and page insertion; proof copy (print and screen); adjustment test print; digital art functions; job setting memory; poster mode; image repeat; overlay (optional); stamping; copy protection"

PRINTER SPECIFICATIONS

Print resolution	1,800 x 600 dpi; 1,200 x 1,200 dpi
Page description language	PCL6 (XL 3.0); PCL 5c; PostScript 3 (CPSI 3016); XPS
Operating systems	Windows XP (32/64) Windows VISTA (32/64) Windows 7 (32/64) Windows 8 (32/64) Windows Server 2003 (32/64) Windows Server 2008 (32/64) Windows Server 2008 R2 (64) Windows Server 2012 (64) Macintosh OS X 10.x Unix, Linux, Citrix
Printer fonts	80 PCL Latin; 137 PostScript 3 Emulation Latin
Print functions	Direct print of PCL, PS, TIFF, XPS, PDF, encrypted PDF files and OOXML (DOCX, XLSX, PPTX); mixmedia and mixplex; "Easy Set" job programming; overlay; watermark; copy protection; carbon copy print

PRINTER SPECIFICATIONS (OPTIONAL)

Print controller	Embedded Fiery IC-414
Controller CPU	Intel Pentium @ 2.6 GHz
Memory/HDD	2 GB/160 GB
Page description language	Adobe PostScript 3 (CPSI 3019) PCL 6/5c
Operating systems	Windows XP (32/64) Windows VISTA (32/64) Windows 7 (32/64) Windows 8 (32/64) Windows Server 2003 (32/64) Windows Server 2008 (32/64) Windows Server 2008 R2 (64) Windows Server 2012 (64) Macintosh OS 9.x/10.x

SCANNER SPECIFICATIONS

Scan speed (mono/colour)	Up to 180 ipm
Scan resolution	Max.: 600 x 600 dpi
Scan modes	Scan-to-eMail (Scan-to-Me) Scan-to-SMB (Scan-to-Home) Scan-to-FTP Scan-to-Box Scan-to-USB Scan-to-WebDAV Scan-to-DPWS Network TWAIN scan
File formats	JPEG; TIFF; PDF; PDF/A 1a and 1b (optional); compact PDF; encrypted PDF; searchable PDF (optional); XPS; compact XPS; PPTX; searchable PPTX (optional); searchable DOCX/XLSX (optional)
Scan destinations	2,100 (single + group); LDAP support
Scan functions	Annotation (text/time/date) for PDF; up to 400 job programs; realtime scan preview

¹ Warm-up time may vary depending on the operating environment and usage

FAX SPECIFICATIONS

Fax standard	Super G3 (optional)
Fax transmission	Analogue i-Fax Colour i-Fax (RFC3949-C) IP-Fax
Fax resolution	Max.: 600 x 600 dpi (ultra-fine)
Fax compression	MH; MR; MMR; JBIG
Fax modem	Up to 33.6 Kbps
Fax destinations	2,100 (single + group)
Fax functions	Polling; time shift; PC-Fax; receipt to confidential box; Receipt to e-mail/FTP/SMB; up to 400 job programs

USER BOX SPECIFICATION

Max. storable documents	Up to 3,000 documents or 10,000 pages
Type of user boxes	Public Personal (with password or authentication) Group (with authentication)
Type of system boxes	Secure print Encrypted PDF print Fax receipt Fax polling
User box functionality	Reprint; combination Download Sending (e-mail/FTP/SMB and fax) Copy box to box

SYSTEM SPECIFICATIONS

System memory	2,048 MB (standard)
System hard disc	250 GB (standard)
Interface	10-Base-T/100-Base-T/1,000-Base-T Ethernet; USB 2.0
Network protocols	TCP/IP (IPv4 / IPv6); IPX/SPX; NetBEUI; AppleTalk (EtherTalk); SMB; LPD; IPP; SNMP; HTTP
Frame types	Ethernet 802.2; Ethernet 802.3; Ethernet II; Ethernet SNAP
Automatic document feeder	Up to 150 originals; A6-A3; 35-210 gsm Dualscan ADF
Printable paper size	A6-SRA3, customised paper sizes; banner paper max. 1,200 x 297 mm
Printable paper weight	52-300 gsm
Paper input capacity	Standard: 3,650 sheets Max.: 6,650 sheets*
Tray 1	500 sheets, A5-SRA3, 52-256 gsm
Tray 2	500 sheets, A5-SRA3, 52-256 gsm
Tray 3	1,500 sheets, A4, 52-256 gsm
Tray 4	1,000 sheets, A4, 52-256 gsm
Large capacity cabinet 1 (optional)	3,000 sheets, A4, 52-256 gsm
Large capacity cabinet 2 (optional)	2,500 sheets, A4-SRA3, 52-256 gsm
Manual bypass	150 sheets, A6-SRA3, custom sizes, banner, 52-300 gsm
Automatic duplexing	A5-SRA3; 52-256 gsm
Finishing modes (optional)	Offset; group; sort; staple; punch; post insertion; z-fold; centre-fold; letter fold; booklet
Output capacity (with finisher)	Max.: 3,300 sheets
Output capacity (without finisher)	Max.: 250 sheets

Stapling	Max.: 100 sheets or 98 sheets + 2 cover sheets (up to 209 gsm)
Stapling output capacity	Max.: 1,000 sheets
Letter fold	Up to 3 sheets
Letter fold capacity	Max.: 30 sheets (tray); unlimited
Booklet	Max.: 20 sheets or 19 sheets + 1 cover sheet (up to 209 gsm)
Booklet output capacity	Max.: 100 sheets (tray); unlimited
Copy/print volume (monthly)	Rec.: 125,000 pages Max.: 250,000 pages
Toner lifetime	Black 47,200 pages; CMY 31,500 pages
Imaging unit lifetime	Black 300,000 pages/1,200,000 pages (Drum/Developer) CMY 155,000 pages
Power consumption	220-240 V / 50/60 Hz Less than 2,1 kW (system)
System dimensions (W x D x H)	650 x 799 x 1,155 mm
System weight	Approx. 221 kg

SYSTEM FEATURES

Security	ISO 15408 EAL3 (in evaluation); IP filtering and port blocking; SSL2; SSL3 and TLS1.0 network communication; IPsec support; IEEE 802.1x support; user authentication; Authentication log; secure print; Hard disc overwrite (8 standard types); Hard disc data encryption (AES 128); Memory data auto deletion; Confidential fax receipt; Print user data encryption; copy protection (Copy Guard, Password Copy) optional
Accounting	Up to 1,000 user accounts; Active Directory support (user name + password + e-mail + smb folder) User function access definition Biometric authentication (finger vein scanner) optional ID card authentication (ID card reader) optional*
Software	PageScope Net Care Device Manager PageScope Data Administrator PageScope Box Operator PageScope Direct Print Print Status Notifier Driver Packaging Utility Log Management Utility

- All specifications refer to A4-size paper of 80 gsm quality.
- The support and availability of the listed specifications and functionalities varies depending on operating systems, applications and network protocols as well as network and system configurations.
- The stated life expectancy of each consumable is based on specific operating conditions such as page coverage for a particular page size (5% coverage of A4). The actual life of each consumable will vary depending on use and other printing variables including page coverage, page size, media type, continuous or intermittent printing, ambient temperature and humidity.
- Some of the product illustrations contain optional accessories.
- Specifications and accessories are based on the information available at the time of printing and are subject to change without notice.
- Konica Minolta does not warrant that any specifications mentioned will be error-free.
- All brand and product names may be registered trademarks or trademarks of their respective holders and are hereby acknowledged.

